



*A Brightest Experience*

davide guglielmi  
contemporary art of travel

#collectingmoments



*When luxury meets adventure:  
Discover the Galapagos  
Islands aboard the Galaxy Sirius*

Immerse yourself in the opulent splendor of the Galaxy Sirius, a lavish vessel masterfully crafted to deliver unparalleled comfort and serenity. Adorned with sophisticated décor and boasting state-of-the-art amenities, this exceptional ship promises an extraordinary sailing experience as you traverse the enchanting Galapagos Islands.



The Galaxy Sirius accommodates up to 16 passengers comfortably.



Explore the best of the Galapagos Islands on a Galaxy Sirius journey, visiting pristine destinations.

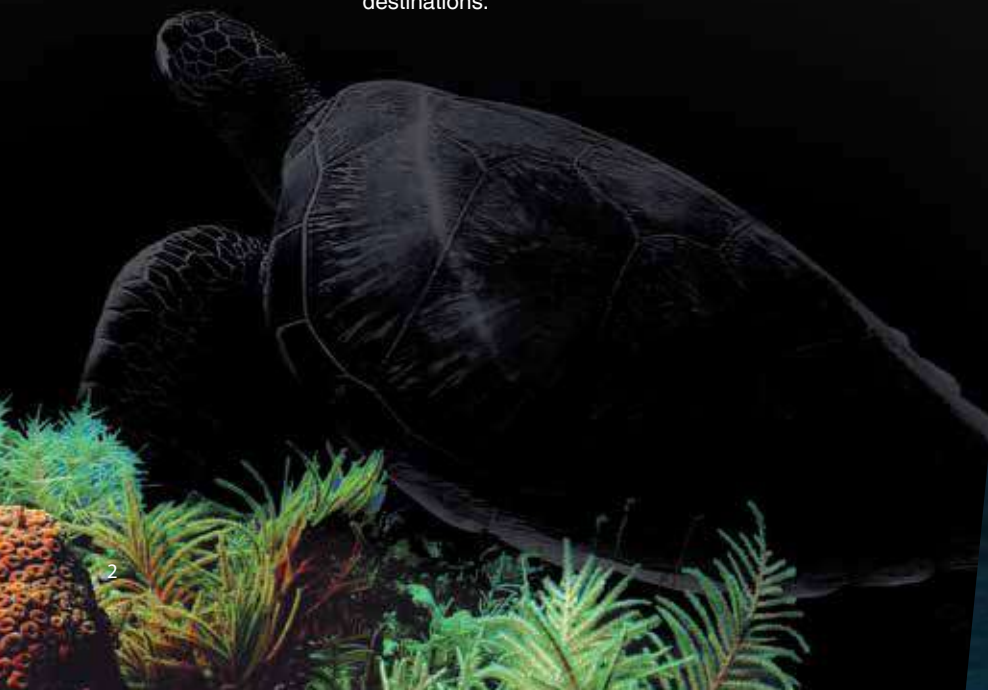



## *Cuisine*

## *Technical Et Safety Features*



### > **Dimensions**

Lenght: 36.62 mts/ 120.14 ft  
Beam: 13.00 mts/ 42.65 ft

### > **Performance**

Cruising speed: 12 knots  
Engines: 2 Cumming Motors Qsm11  
de 450 HP

### > **Capacity**

16 passengers, 8 Crew Members  
1 Cruise Director , 2 bilingual guides

### > **Operation and consumption**

110V and 220V

## Deck Plan

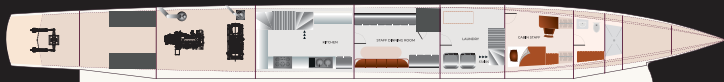

LOWER DECK

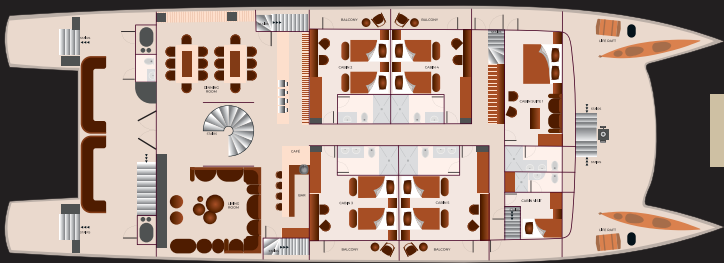

MAIN DECK

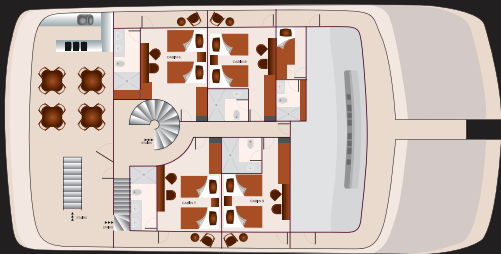

UPPER DECK

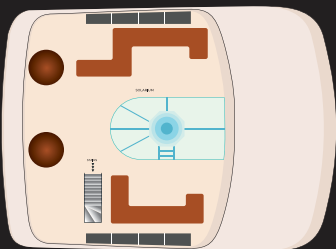

MASTERLY DECK

## Salvage and Security Equipment

Your safety is our priority. The Galaxy Sirius has state-of-the-art safety gear, including life vests, emergency rafts, and advanced communication systems.



- ✓ 35 life jackets
- ✓ Fire extinguishers 10 lb and 2lb.
- ✓ Four lifebuoys 9mm
- ✓ Fire hoses 15m.
- ✓ Flare guns, smoke signals, SOS flashlights, and other visual signals.
- ✓ Fire detectors and complete fire protection system.
- ✓ Two survival rafts, 25 passengers each.