

The PONANT Explorers : *Le Lapérouse, Le Champlain, Le Bougainville, Le Dumont-d'Urville, Le Bellot and Le Jacques-Cartier*

With this subtle blend of the wish to explore the most remote parts of the world and the comfort of an intimate ship, these six yachts are fitted with innovative and eco-friendly equipment.

davide guglielmi
contemporary art of travel

#collectingmoments



Length: 131 m
Width: 18 m
Draft: 4.7 m
Average cruising speed: 13.5 knots

Number of staterooms and suites: 92
Crew members: 118
Installed electrical power: 6,400 KW
Years of delivery: from 2018 to 2020



The PONANT Explorers series is designed to enable you to experience the expedition in a different way. Equipped with a multi-sensory underwater lounge, the *Blue Eye*, and the latest technologies to limit the impact on the environment, *Le Lapérouse*, *Le Champlain*, *Le Bougainville*, *Le Dumont-d'Urville*, *Le Bellot* and *Le Jacques-Cartier* enable you to make stopovers in remote regions.





1. The *Blue Eye*, multi-sensory underwater lounge
2. The Spa, in partnership with Sothys
3. The pool deck and its solarium
4. The panoramic restaurant, open to the outside
5. The theatre, where conferences, shows and performances take place

1. *Le Bougainville*
2. The Owner's suite
3. The Owner's suite, its private terrace and jacuzzi
4. The Privilege Suite

Amenities

- Individually controlled airconditioning
- Stateroom layout: king-size bed, or twin beds, communicating Staterooms available (Children welcome)
- Minibar
- Flat-screen satellite TV
- Video on demand
- Bose Bluetooth speaker
- Desk with stationery
- Safe
- Hermès bath products*
- Dressing table, bath robes, hairdryer
- Direct line telephone
- 110V American (two flat pins)/220V European (round sockets with two round pins)
- 24hr room service
- Inclusive internet access Wifi**

**Aboard Le Jacques-Cartier, Clarins. **Depending on the navigation areas, the Wifi may not be accessible for reasons beyond our control.*

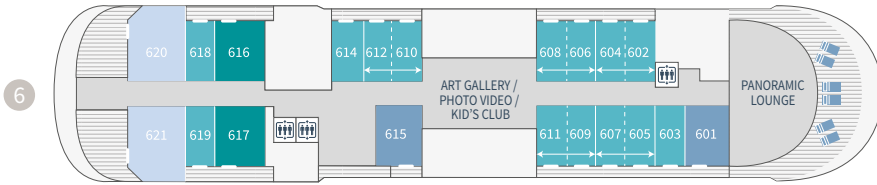
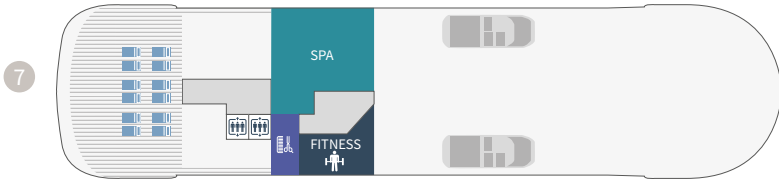

(1) Aboard *Le Lapérouse* and *Le Champlain*, the Owner's Suite is located on deck 6 (Suite 621).

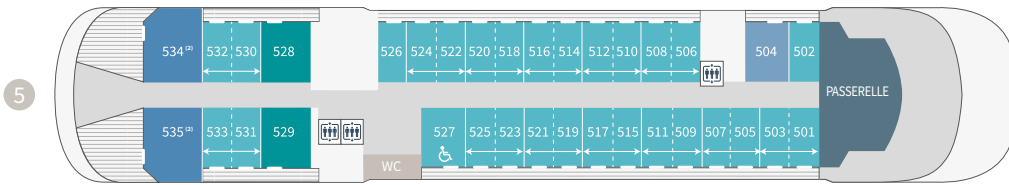

(2) Aboard *Le Lapérouse* and *Le Champlain*, the Suites 534 and 535 located on deck 5 are Grand Deluxe Suites.

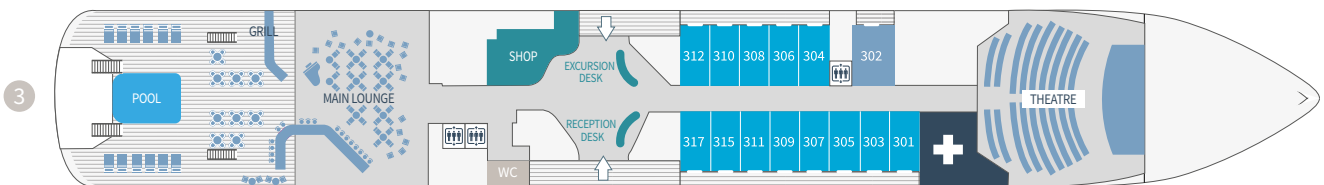
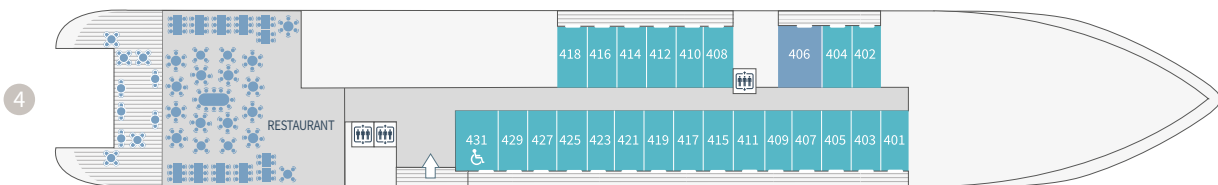

- Owner's Suite
Deck 5 (Deck 6 aboard *Le Lapérouse* and *Le Champlain*)
- Grand Deluxe Suites
Deck 5 - 6
- Privilege Suites
Deck 5 - 6
- Prestige Suites
Deck 5 - 6
- Deluxe Suites
Deck 3 - 4 - 5 - 6
- Prestige Staterooms
Deck 4 - 5 - 6
- Deluxe Staterooms
Deck 3

Discover your Stateroom

OWNER'S SUITE

(45 sq.m/484 sq.ft + 40 sq.m/430 sq.ft private terrace* with hot tub and sliding bay windows)



(*30 sq.m/323 sq.ft of private terrace aboard *Le Lapérouse* and *Le Champlain*)

3 GRAND DELUXE SUITES

(45 sq.m/484 sq.ft + 30 sq.m/323 sq.ft private terrace with sliding bay windows; on deck 5: 40 sq.m/430 sq.ft private terrace with hot tub and sliding bay windows)



(*except aboard *Le Lapérouse* and *Le Champlain*)

4 PRIVILEGE SUITES

(32 sq.m/344 sq.ft + 8 sq.m/86 sq.ft private balcony with sliding bay window)



18 PRESTIGE SUITES

(38 sq.m/409 sq.ft + 8 sq.m/86 sq.ft private balcony with sliding bay window)

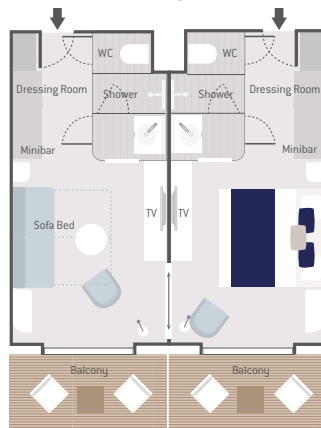

66 PRESTIGE STATEROOMS

(19 sq.m/204 sq.ft + 4 sq.m private/43 sq.ft balcony with sliding bay window)



5 DELUXE SUITES

(27.5 sq.m /291 sq.ft + 6 sq.m/65 sq.ft private balcony with sliding bay window)



13 DELUXE STATEROOMS

(19 sq.m/204 sq.ft + 4 sq.m/43 sq.ft private balcony with French window)

