

A large cruise ship, the Le Commandant Charcot, is sailing through a blue, icy sea. The ship is dark blue with white accents and is surrounded by numerous icebergs of various sizes. In the background, there are snow-covered mountains and a clear blue sky. The foreground shows a snowy, rocky slope.

Le Commandant Charcot

In reference to the Gentleman of the poles whose name it bears, *Le Commandant Charcot* was designed to make you fully experience real polar odysseys and lead you in the footsteps of the great explorers, but against a refined backdrop.

davide guglielmi
contemporary art of travel

#collectingmoments

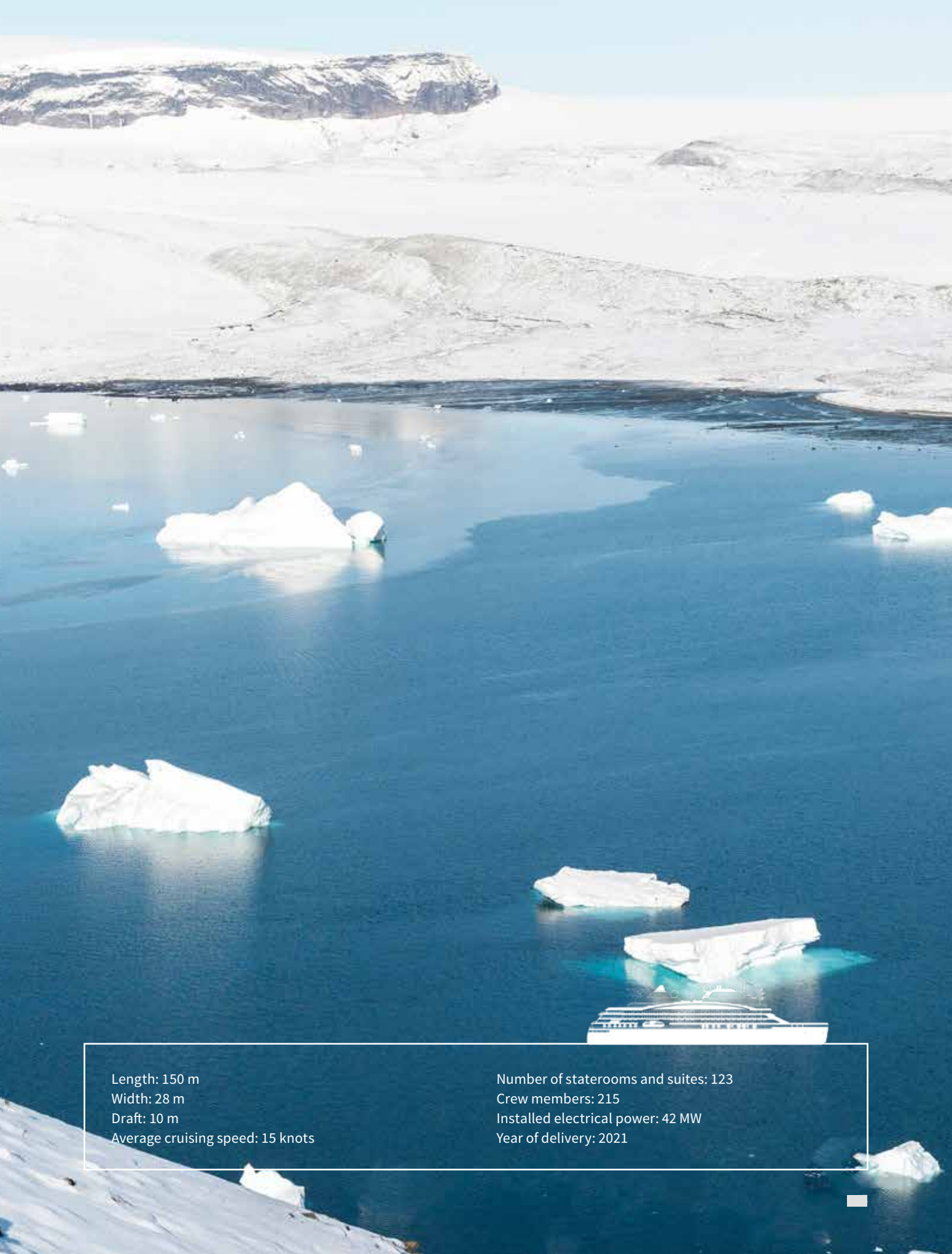

Length: 150 m
Width: 28 m
Draft: 10 m
Average cruising speed: 15 knots

Number of staterooms and suites: 123
Crew members: 215
Installed electrical power: 42 MW
Year of delivery: 2021



Le Commandant Charcot encapsulates an **eco-friendly design** comprising a **hybrid** propulsion system never before seen in the polar regions. In total communion with nature, it will carry you safely and comfortably beyond known lands. **Two research laboratories on board** allow scientists to collect data that will increase our knowledge of the poles.





1



2



3



4

1. The sauna in the wellness area, which also includes the Biological Recherche Spa, hair and nail salon, fitness room, snow cabin
2. Pool area, with a heated indoor swimming pool, a relaxation area
3. The atrium
4. The Sila restaurant [the sky, the outside], deck 9
5. The Blue Lagoon area, deck 9

1. *Le Commandant Charcot*

2. The first floor of the Duplex Suite, deck 6
3. The sleeping area on the Owner's Suite, deck 8
4. The Owner's Suite living room, deck 8

Amenities

- Private balcony for all our Cabins and Suites
- Terrace for the Duplex Suites and the Owner's Suite
- Butler service and priority boarding: Owner's Suite, Duplex Suites, Privilege Suites and Grand Prestige Suites
- Individually controlled airconditioning
- Stateroom layout: king-size bed, or twin beds, communicating staterooms available, children welcome
- Minibar and 24hr room service
- Satellite TV channels (availability dependent on navigation)
- Selection of videos on demand
- Bose Bluetooth speaker
- Safe
- Selection of Dyprique Paris top-of-the-line bath products
- Dressing table, bath robes, hairdryer
- Direct line telephone
- 110V American (two flat pins)/220V European (round sockets with two round pins)
- Internet access Wifi*

**Depending on the navigation areas, the Wifi may not be accessible for reasons beyond our control.*



- Owner's Suite
- Duplex Suites
- Privilege Suites
Deck 8
- Grand Prestige Suites
Deck 6
- Prestige Suites
Deck 7 - 8
- Deluxe Suites
Deck 6 - 7 - 8
- Prestige Staterooms
Deck 6 - 7 - 8

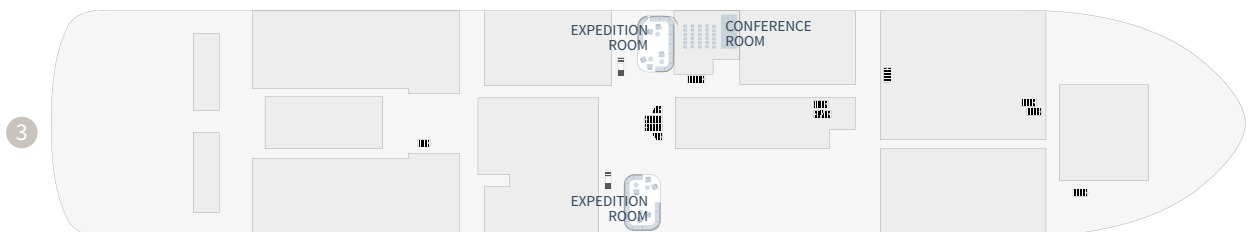
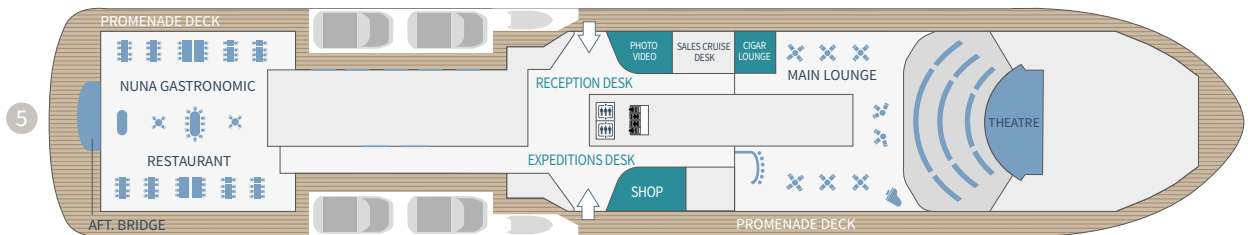
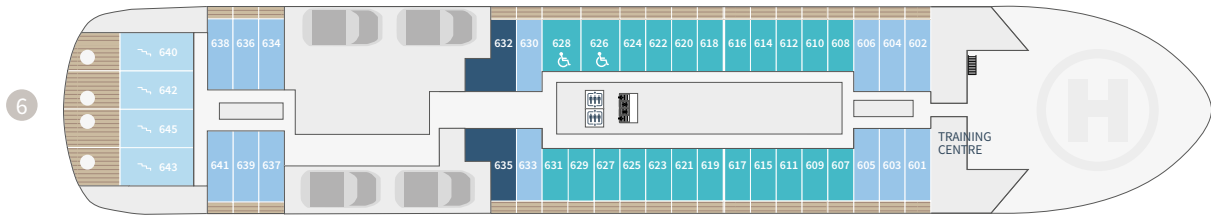
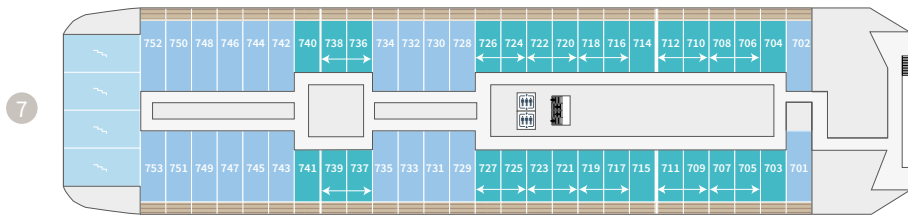
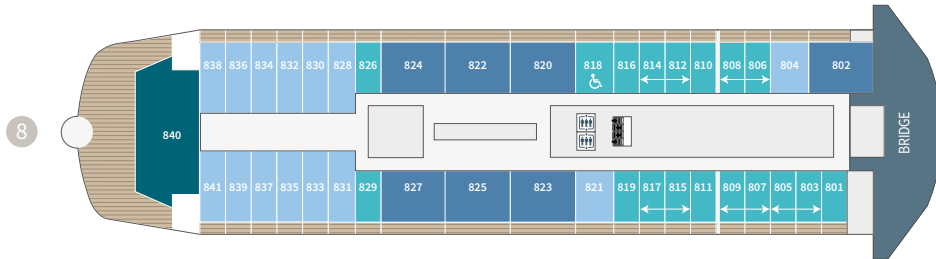

Discover your Stateroom

OWNER'S SUITE (115 sq.m/1,237 sq.ft + 186 sq.m/2,002 sq.ft private terrace with hot tub - balneo bathtub)

2 GRAND PRESTIGE SUITES (42 sq.m/452 sq.ft + 5 sq.m/54 sq.ft private balcony)

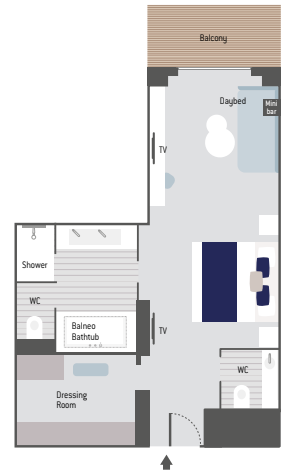
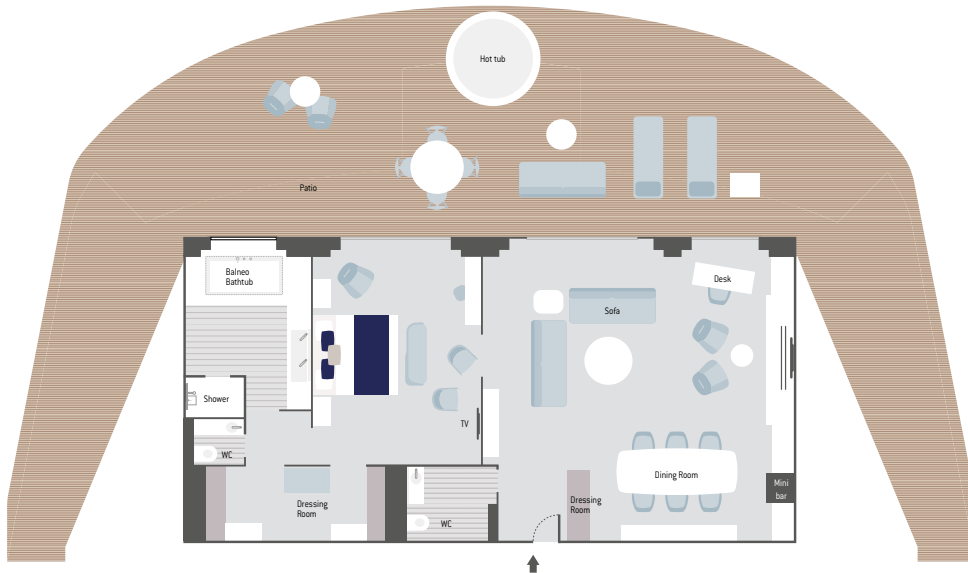

7 PRIVILEGE SUITES (48 sq.m/516 sq.ft + 12.5 sq.m/134.5 sq.ft private balcony - balneo bathtub)

17 PRESTIGE SUITES (40 sq.m/430 sq.ft + 10 sq.m/107 sq.ft private balcony)

4 DUPLEX SUITES (94 sq.m/1,011 sq.ft + 26 sq.m/279 sq.ft private terrace with hot tub - balneo bathtub)

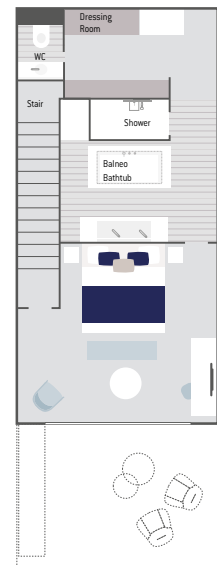
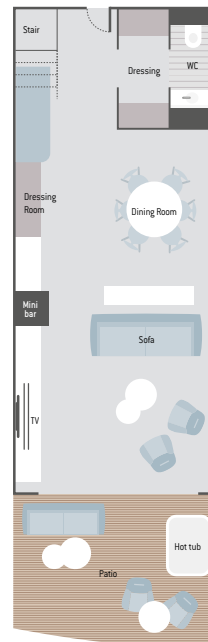
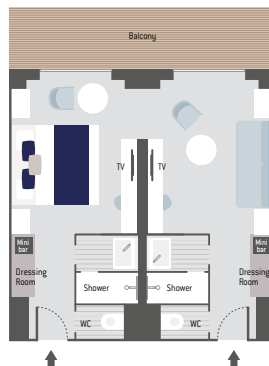

50 DELUXE SUITES (28 sq.m/301 sq.ft + 5 sq.m/53 sq.ft private balcony)

71 PRESTIGE STATEROOMS (20 sq.m/215 sq.ft + 5 sq.m/53 sq.ft private balcony)

